

For Lease  
Office Suites  
2,475 & 2,500± SF



## One Cumberland Place

Bangor, Maine

### Property Highlights

- Class A office suites
- On-site professional management
- Excellent Downtown Bangor location

### Property Description

We are pleased to offer multiple Class A office suites for lease in one of Bangor's premier office buildings. One Cumberland Place is ideally located in Downtown Bangor less than 2± miles from the Maine Turnpike/I-95. Tenants include Robinson Insurance and Financial, Creative Imaging Group, Bangor Children's Dentistry, Cumberland Title, Northern Light Health Foundation as well as others.



### Broker Contact

TC Haffenreffer

Sylas Hatch

tc@dunhamgroup.com

shatch@dunhamgroup.com

## Property Overview

Landlord	RSC Realty Holdings
Assessor's Reference	Map 40, Lot 52
Building Size	40,200± SF
Lot Size	3.67± acres
Available Space	Suite 108 2,500± SF Suite 308/310 2,475± SF
Space breakdown	See attached floor plans
Parking	Free ample paved parking on-site
Zoning	Urban Service District

## Miscellaneous

- Fully ADA accessible
- Access to a shared conference room
- Central mailroom
- Professional waste disposal and recycling
- Prominent Downtown Bangor location

FOR LEASE : \$15.00 - 18.00/SF MG  
Tenant responsible for plugs and lights.

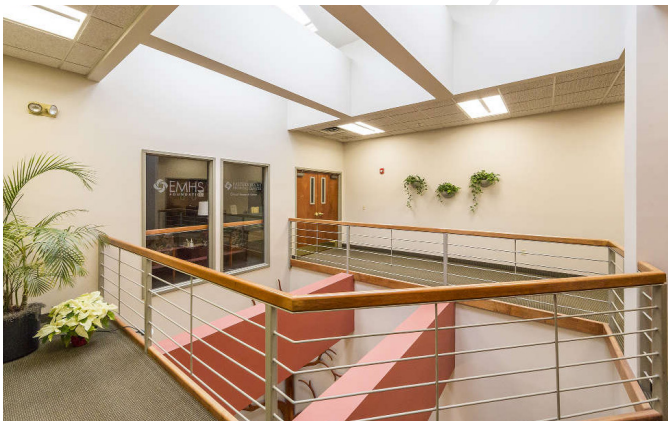

# One Cumberland Place



The information contained herein has been given to us by the owner of the property or other sources we deem reliable. We have no reason to doubt its accuracy, but we do not guarantee it. All information should be verified prior to purchase or lease.