

For Lease
Office Suites
2,475 & 2,500± SF



One Cumberland Place

Bangor, Maine

Property Highlights

- Class A office suites
- On-site professional management
- Excellent Downtown Bangor location



Property Description

We are pleased to offer multiple Class A office suites for lease in one of Bangor's premier office buildings. One Cumberland Place is ideally located in Downtown Bangor less than 2± miles from the Maine Turnpike/I-95. Tenants include Robinson Insurance and Financial, Creative Imaging Group, Bangor Children's Dentistry, Cumberland Title, Northern Light Health Foundation as well as others.

Broker Contact

TC Haffenreffer

Sylas Hatch

tc@dunhamgroup.com

shatch@dunhamgroup.com

One Cumberland Place

Property Overview

Landlord	RSC Realty Holdings	
Assessor's Reference	Map 40, Lot 52	
Building Size	40,200± SF	
Lot Size	3.67± acres	
Available Space	Suite 108	2,500± SF
	Suite 308/310	2,475± SF
Space breakdown	See attached floor plans	
Parking	Free ample paved parking on-site	
Zoning	Urban Service District	

Miscellaneous

- Fully ADA accessible
- Access to a shared conference room
- Central mailroom
- Professional waste disposal and recycling
- Prominent Downtown Bangor location

FOR LEASE : \$15.00 - 18.00/SF MG
Tenant responsible for plugs and lights.

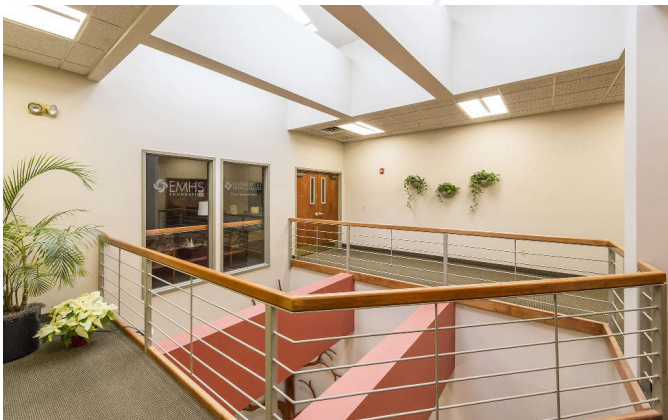

One Cumberland Place

