

For Lease In-line Retail

2,000 - 29,000± SF



Elm Plaza Waterville, Maine

Property Highlights

- In-line Retail Space
- Waterville's Best Retail Location
- Ideally located just off I-95, Exit 35

Property Description

We are pleased to present for lease in-line space in Waterville's best retail location, Elm Plaza. This is an ideal location just off I-95, Exit 35. Anchors include Hannaford and JCPenney, as well as a new Hobby Lobby. Abutters include Walmart Superstore, Home Depot, Staples and Harbor Fright Tools.



Broker Contact

Charlie Craig

207.773.7100

charlescraig@dunhamgroup.com

www.dunhamgroup.com

Property Overview

Owner	Waterville Shopping Trust
Available Space	2,000 - 29,000± SF
Additional Tenants	Olympia Sports, Maurices, Bull Moose Music, Bath & Body Works, Verizon, Hobby Lobby, Hannaford, Subway, Rent A Center, and more
CAM & Taxes	\$3.21/SF

FOR LEASE : \$15.50/SF NNN



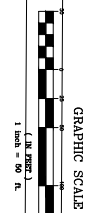
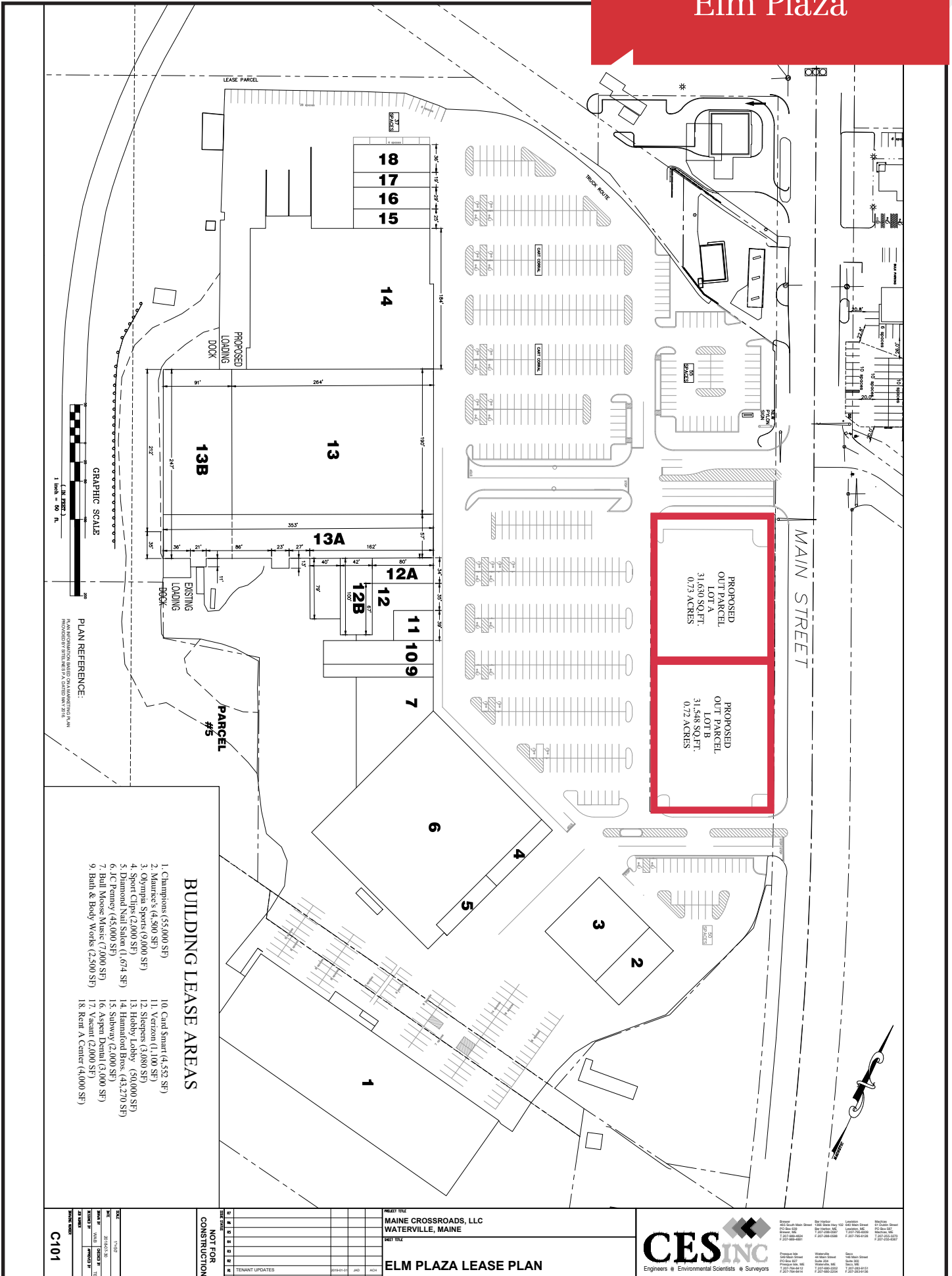

PLAN REFERENCE:
 PLAN INFORMATION BOARD ON ALBERTSONS PLAZA
 PROPOSED BUILDINGS IN A CIRCLED AREA ONLY

- ### BUILDING LEASE AREAS
1. Champions (35,000 SF)
 2. Maurice's (4,500 SF)
 3. Olympia Sports (9,000 SF)
 4. Sport Clips (2,000 SF)
 5. Diamond Nail Salon (1,674 SF)
 6. J.C. Penney (45,000 SF)
 7. Bull Moose Music (7,000 SF)
 8. Bath & Body Works (2,500 SF)
 9. Card Smart (4,552 SF)
 10. Verizon (1,100 SF)
 11. Sleepers (3,080 SF)
 12. Hobby Lobby (50,000 SF)
 13. Hannaford Bros. (43,270 SF)
 14. Subway (2,000 SF)
 15. Aspen Dental (3,000 SF)
 16. Vacant (2,000 SF)
 17. Vacant (2,000 SF)
 18. Rent A Center (4,000 SF)

NO.	DATE	DESCRIPTION
1	08/11/11	TENANT UPDATES

PROJECT TITLE	MAINE CROSSROADS, LLC WATERVILLE, MAINE
SHEET TITLE	ELM PLAZA LEASE PLAN

CES INC
 Engineers • Environmental Scientists • Surveyors

General 605 South Main Street Waterville, ME 05671 Tel: 207-866-8881	Site Director 1400 South Main Street Waterville, ME 05671 Tel: 207-866-8881	Surveyors 1400 South Main Street Waterville, ME 05671 Tel: 207-866-8881	Landscapers 1400 South Main Street Waterville, ME 05671 Tel: 207-866-8881	Environmental 1400 South Main Street Waterville, ME 05671 Tel: 207-866-8881
---	--	--	--	--

The information contained herein has been given to us by the owner of the property or other sources we deem reliable. We have no reason to doubt its accuracy, but we do not guarantee it. All information should be verified prior to purchase or lease.