

FOR LEASE

Industrial Building

32,135± SF | \$9.50/SF NNN



80 Pine Tree Industrial Parkway, Portland

Property Highlights

- Approximately 1/2 mile from Maine Turnpike/I-95, Exit 47
- 1200 amp, 480 volt, 3-phase power
- Fourteen (14) loading dock doors
- 6,000± SF storage shed
- Available April 2023

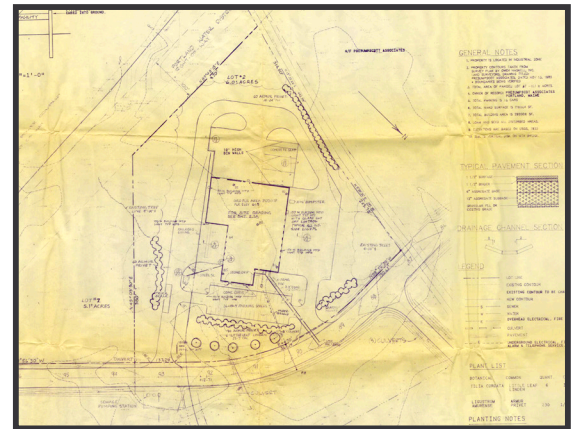

Property Description

We are pleased to offer a 32,135± SF industrial building in Pine Tree Industrial Park that is zoned for outdoor storage. The building can be used for manufacturing or warehousing.



Broker Contact

Greg Hastings, SIOR
Tom Dunham, SIOR

ghastings@dunhamgroup.com
tdunham@dunhamgroup.com

Property Overview

Owner	80 Pine Tree IP, LLC
Assessor's Reference	Map 254, Block A, Lot 2
Deed Reference	Book 31209, Page 049
Building Size	32,135± SF
Lot Size	6.02± acres
Space Breakdown	Office : 5,292± SF Warehouse : 26,843± SF
Annual Taxes	\$30,208.25 (FY '21 - '22)
Zoning	Industrial (I-1)
Year Built	1986
Building Construction	Pre-engineered steel frame with metal siding
Roof	EPDM (2008)
Floor	8" concrete slab in manufacturing area
Utilities	Municipal water & sewer, LP gas
Ceiling Height	17 - 18'±
Loading Doors	Fourteen (14)
Overhead Doors	Two (2) drive-in doors
Heat	LP gas-fired infrared suspended hot air units
Electrical	1200 amp, 480 V, 3-phase
Lighting	Combination of T-5 fluorescent and LED fixtures
Sprinkler System	Yes - wet system
Stormwater Tax	City of Portland Water Tax Assessment - \$735/month
Rail Siding	PAN AM siding into site (not currently active)
Miscellaneous	6,000± SF storage shed

FOR LEASE : \$9.50/SF NNN