

# FOR LEASE

## Industrial Space

8,000 - 12,000± SF | \$9.95/SF NNN



## 419 Presumpscot Street, Portland

### Property Highlights

- 1,500± SF Office area
- Up to nine (9) drive-in overhead doors
- Four (4) loading dock doors
- Located 1± mile from I-295, Exit 8



### Property Description

We are pleased to offer 8,000 - 12,000± SF of industrial/warehouse space for lease at 419 Presumpscot Street, Portland. The property is comprised of a 16,000± SF building with twelve (12) drive-in overhead doors and ample on-site parking. The rear of the property is visible from I-295.

#### Broker Contact

Greg Hastings, SIOR | [greg@dunhamgroup.com](mailto:greg@dunhamgroup.com)  
207.773.7100 | [dunhamgroup.com](http://dunhamgroup.com)



## Property Overview

Owner	Srednas, LLC
Building Size	16,000± SF
Available Space	Up to 12,000± SF
Lot Size	4.95± acres
Assessor's Reference	Map 419, Black A, Lot 2
Annual Taxes	\$36,267.09 (FY 23/24) or \$1.65/SF
Zoning	Industrial Moderate (IM)
Building Construction	Steel frame with steel siding
Building Age	1974
Roof	Sloped standing seam metal roof
Flooring	Concrete slab
Utilities	Municipal water, septic system, LP gas
Electrical	400 Amp, 3-phase
Lighting	Fluorescent fixtures throughout
Ceiling Height	14-16'±
Overhead Doors	Up to nine (9) 12' x 16' drive-in OHDs
Loading Docks	Four (4) 8' x 8' truck dock doors
HVAC	Warehouse: LP gas FHA and infrared heaters; Office: HVAC
Sprinkler System	Wet system
Parking	Ample on-site parking and storage
Miscellaneous	Trench drains

**FOR LEASE : \$9.95/SF NNN**

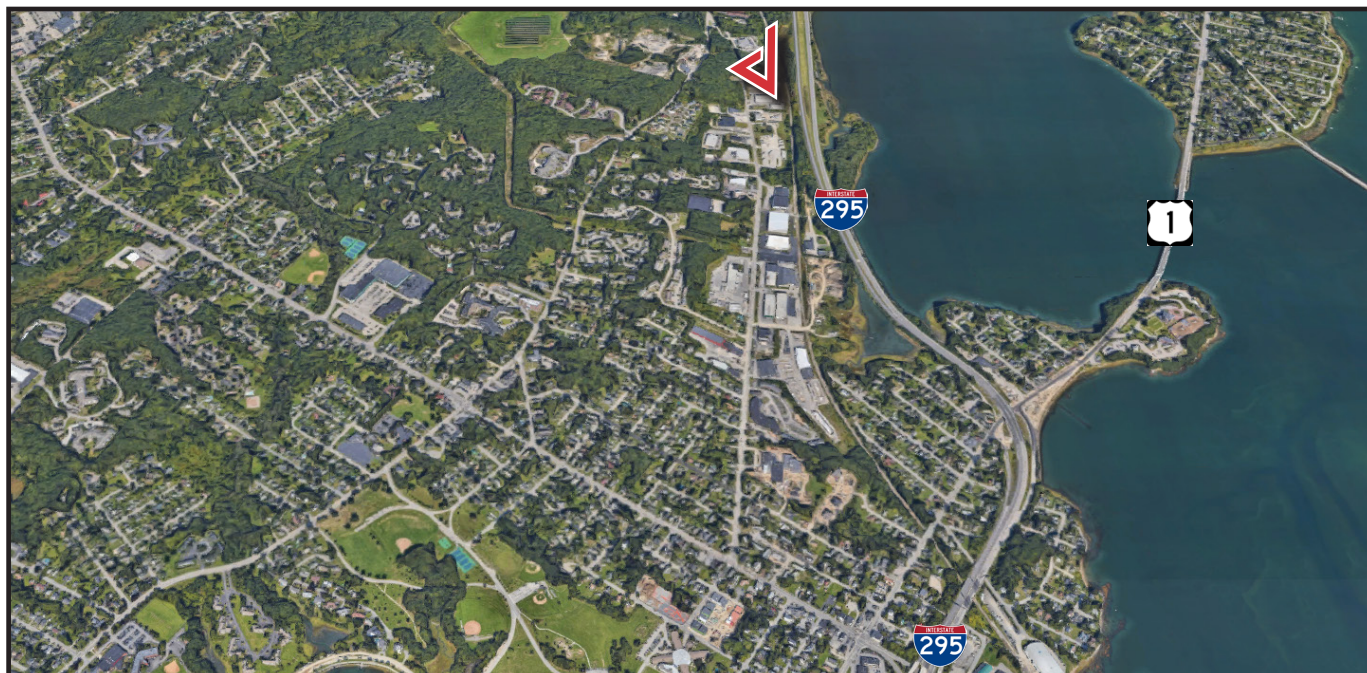



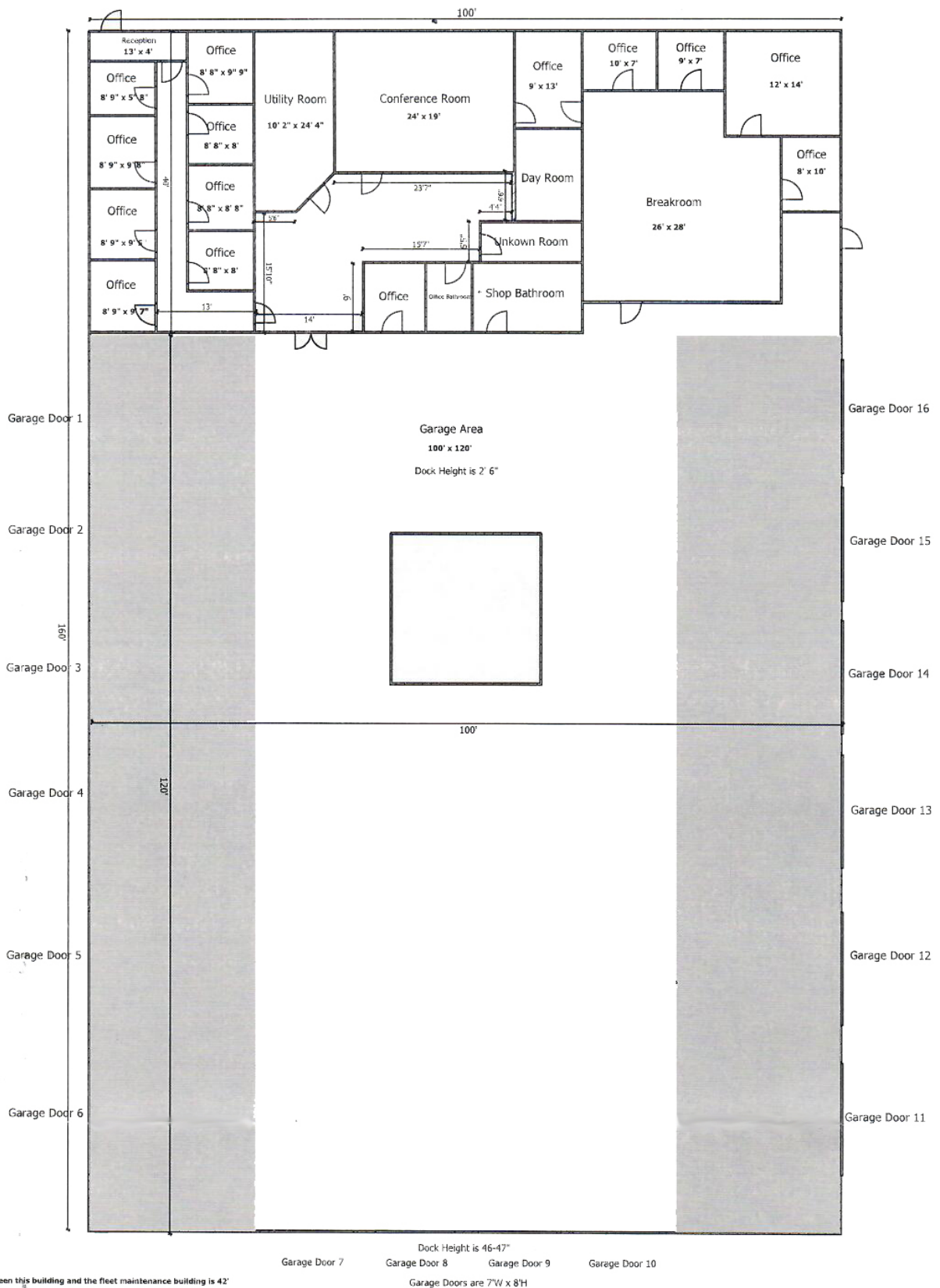

The information contained herein has been given to us by the owner of the property or other sources we deem reliable. We have no reason to doubt its accuracy, but we do not guarantee it. All information should be verified prior to purchase or lease.



