



FOR LEASE

Dry Storage Space

2,800± SF | \$2,800/month

31 Diamond Street, Portland

Property Highlights

- *Desirable East Bayside location*
- *Excellent visibility and signage potential*
- *Flexible zoning - multiple uses permitted*
- *Free on-site parking*

Property Description

We are pleased to offer a 2,800± SF dry storage space for lease. The property is located in the East Bayside District which houses breweries, coffee roasters, distilleries, furniture stores, parts distributors, and retailers. East Bayside is one of Portland's most desirable neighborhoods due to its location, easy access, and free parking.



Tom Moulton, CCIM, SIOR | tmoulton@dunhamgroup.com

Katie Allen Breggia | katie@dunhamgroup.com

207.773.7100 | www.dunhamgroup.com



31 Diamond Street

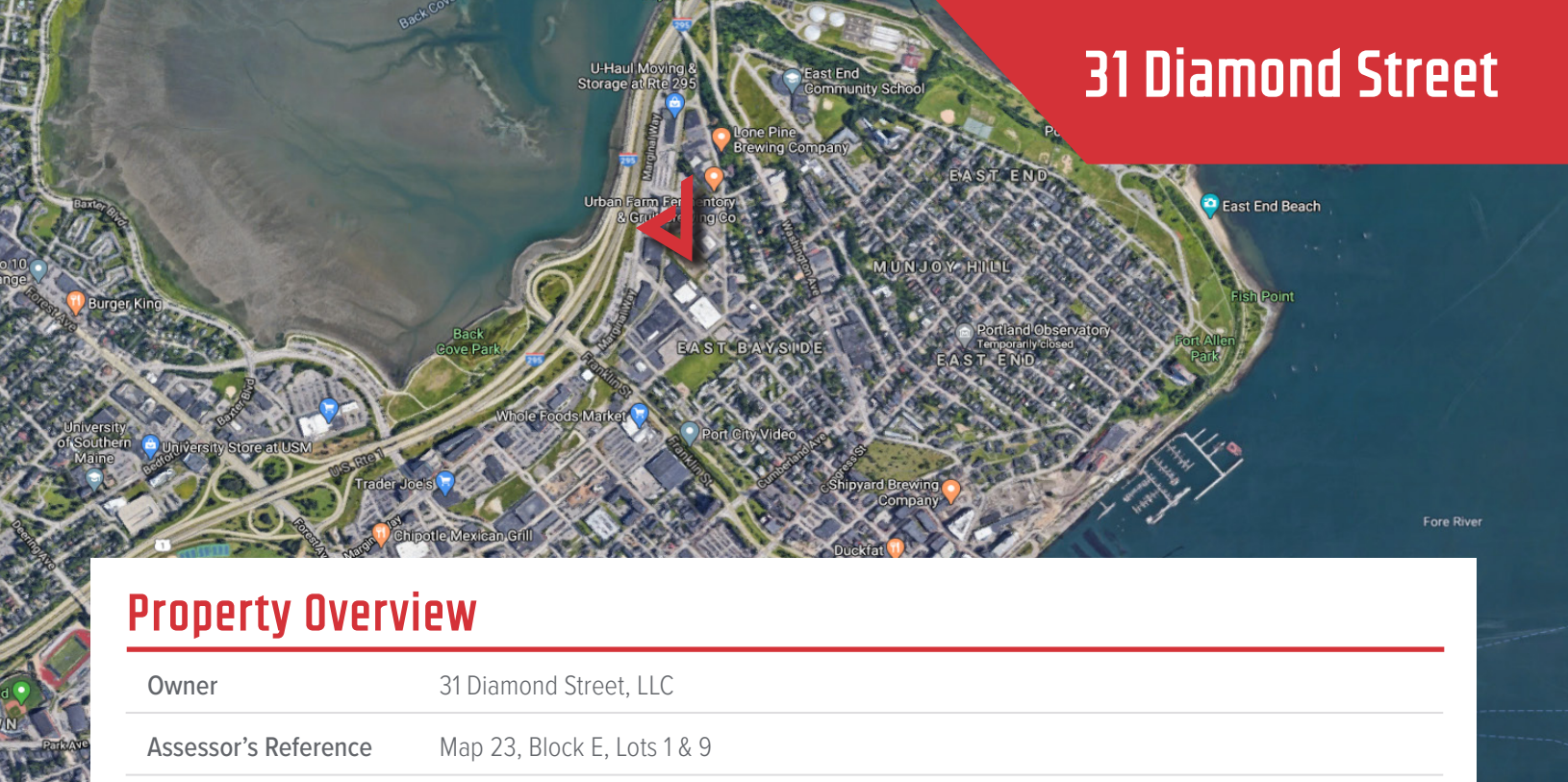

Property Overview

Owner	31 Diamond Street, LLC
Assessor's Reference	Map 23, Block E, Lots 1 & 9
Available Space	2,800 ± SF (no heat or utilities)
Lot Size	0.98± acres
Construction	Concrete block & steel
Roof	Pitched
Ceiling Height	8' - 11'±
Lighting	New commercial fixtures
Electrical	1200 amp, 3-phase, 4-wire
Zoning	Industrial Zone (ILB)
Overhead Doors	One (1)

FOR LEASE: \$2,500/mo Gross
Space has no heat or utilities

JOIN OTHER TENANTS :



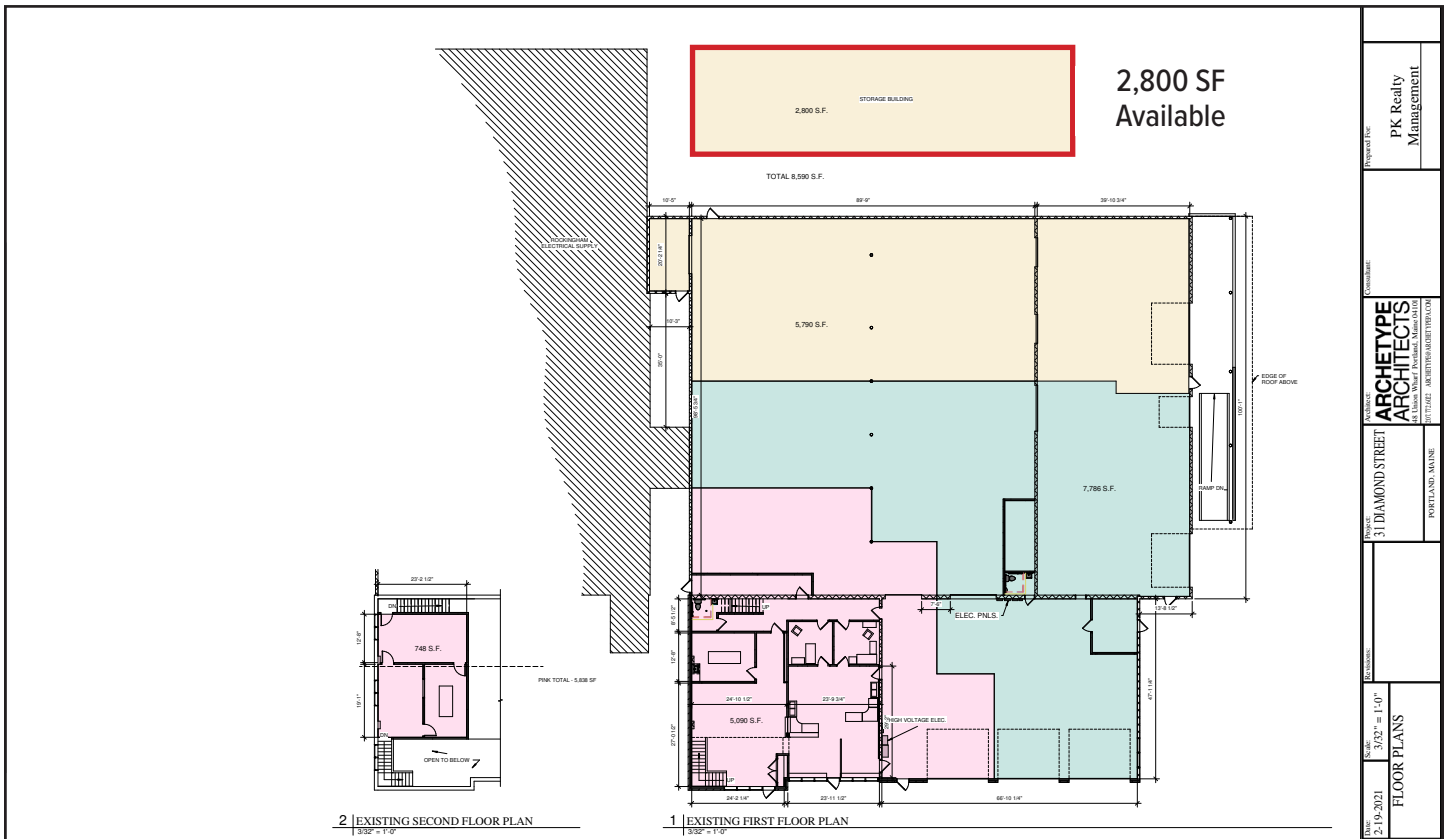
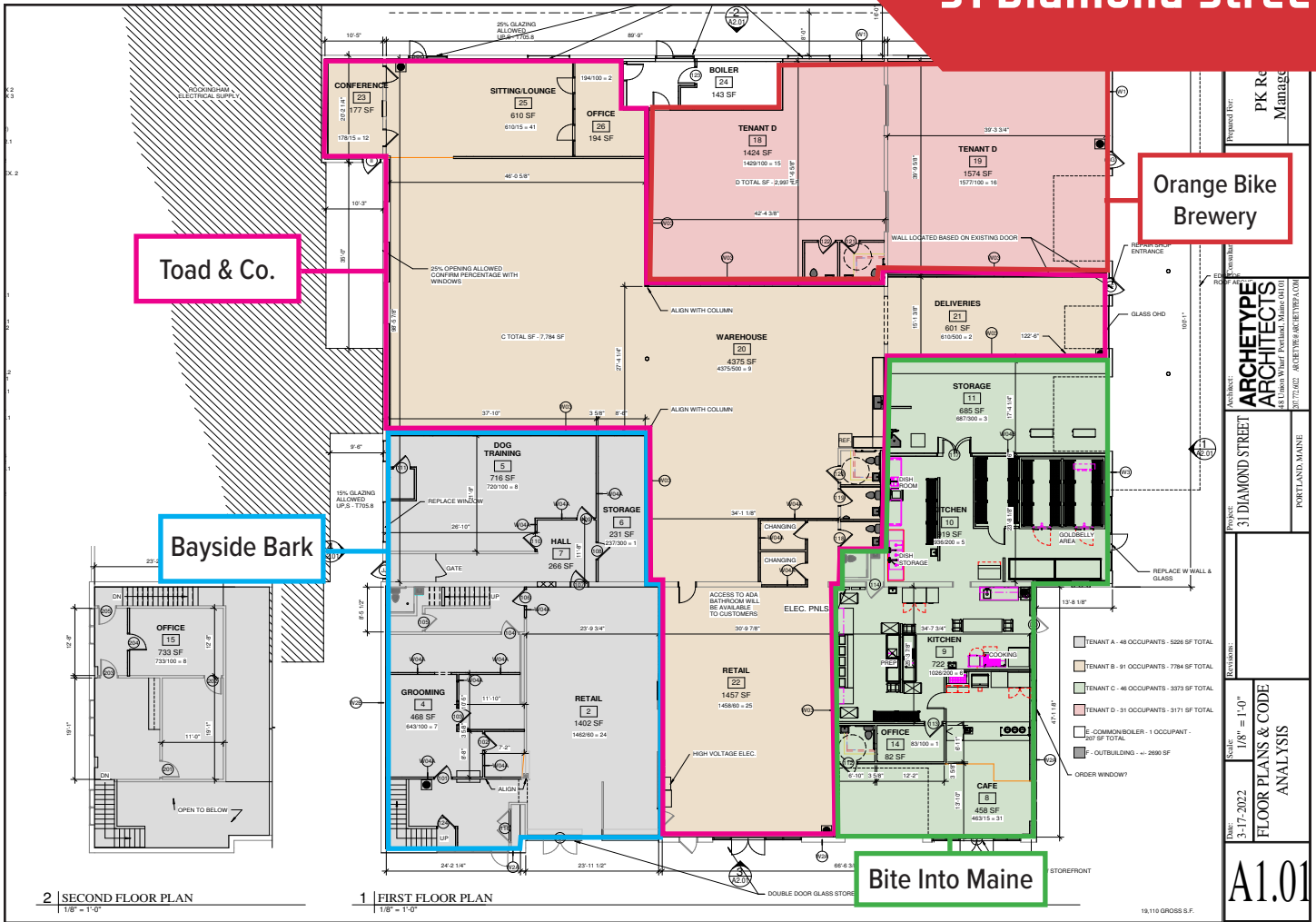

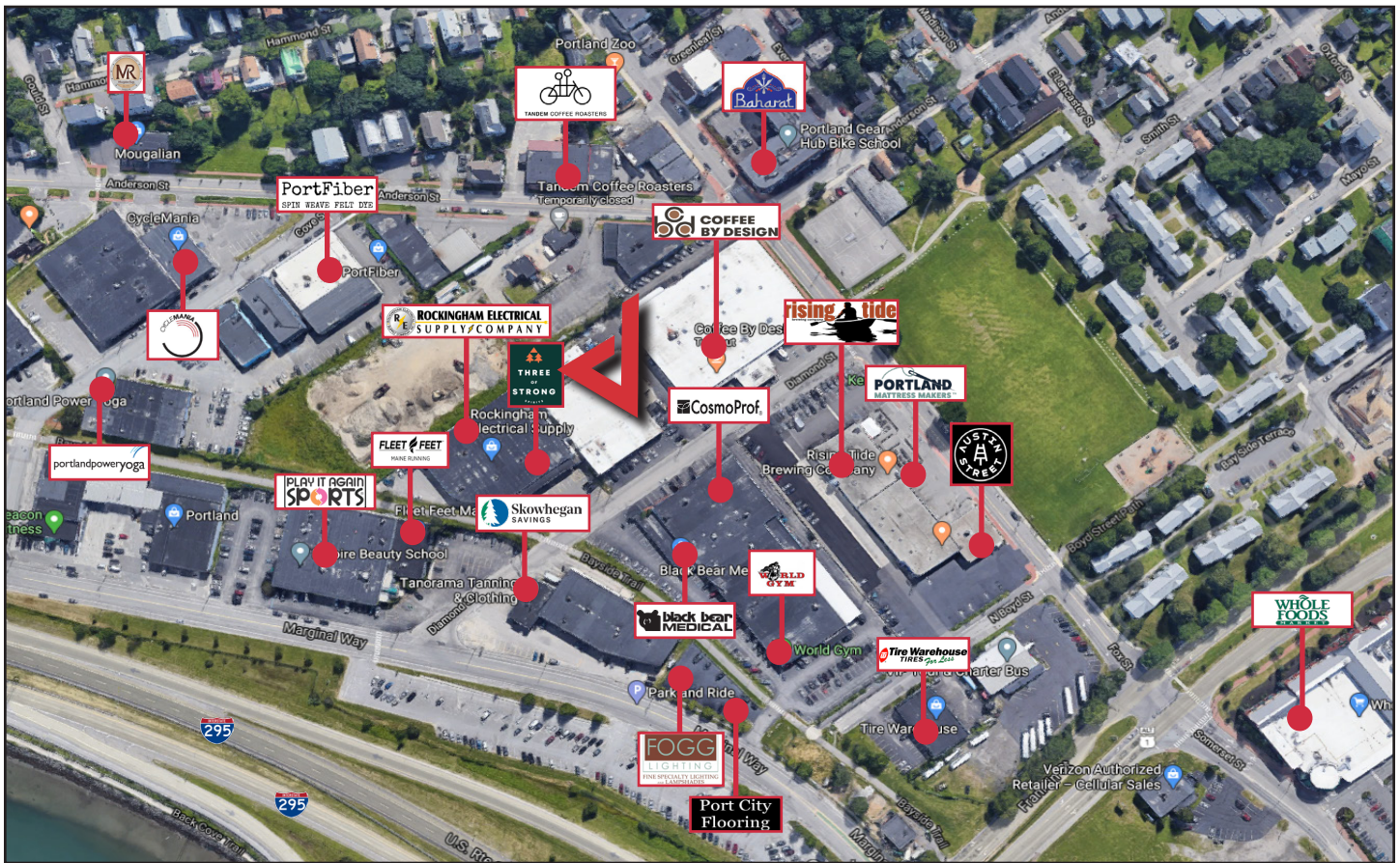

The information contained herein has been given to us by the owner of the property or other sources we deem reliable. We have no reason to doubt its accuracy, but we do not guarantee it. All information should be verified prior to purchase or lease.