

For Lease In-line Retail

2,000 - 29,000± SF



Elm Plaza Waterville, Maine

Property Highlights

- In-line Retail Space
- Waterville's Best Retail Location
- Ideally located just off I-95, Exit 35

Property Description

We are pleased to present for lease in-line space in Waterville's best retail location, Elm Plaza. This is an ideal location just off I-95, Exit 35. Anchors include Hannaford and JCPenney, as well as a new Hobby Lobby. Abutters include Walmart Superstore, Home Depot, Staples and Harbor Fright Tools.



Broker Contact

Charlie Craig

207.773.7100

charlescraig@dunhamgroup.com

www.dunhamgroup.com

Property Overview

Owner	Waterville Shopping Trust
Available Space	2,000 - 29,000± SF
Additional Tenants	Olympia Sports, Maurices, Bull Moose Music, Bath & Body Works, Verizon, Hobby Lobby, Hannaford, Subway, Rent A Center, and more
CAM & Taxes	\$3.21/SF

FOR LEASE : \$15.50/SF NNN



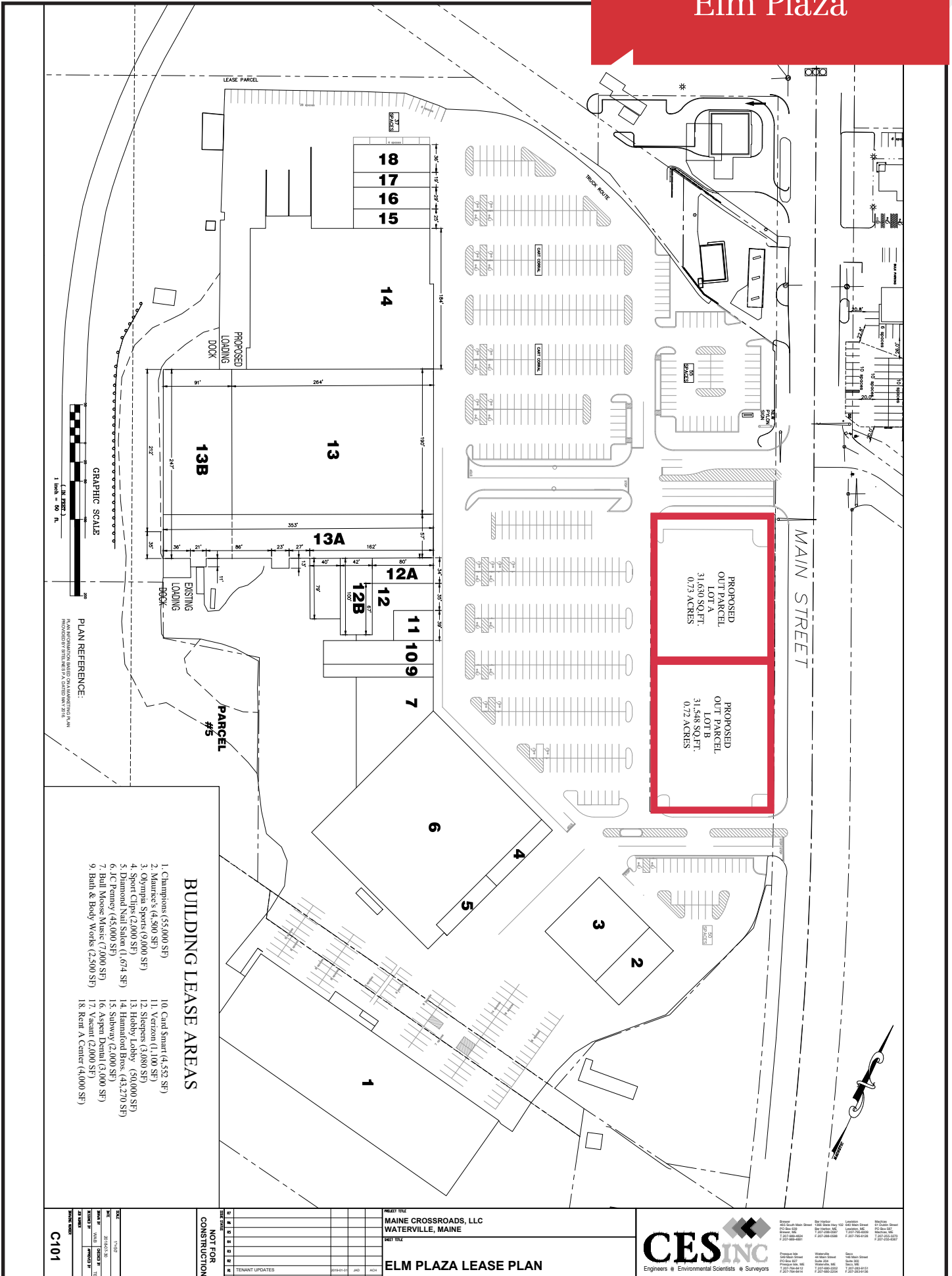

NOT FOR CONSTRUCTION	PROJECT TITLE MAINE CROSSROADS, LLC WATERVILLE, MAINE	CES INC Engineers • Environmental Scientists • Surveyors
	SHEET TITLE ELM PLAZA LEASE PLAN	
REVISIONS NO. DATE BY 1 10/1/14 JAC 2 10/1/14 JAC	TITLES DATE DRAWN BY CHECKED BY PROJECT MGR DATE	PROJECT NO. 10101

The information contained herein has been given to us by the owner of the property or other sources we deem reliable. We have no reason to doubt its accuracy, but we do not guarantee it. All information should be verified prior to purchase or lease.