

# FOR LEASE

## Retail Space

3,980± SF | \$13.00/SF NNN



## 110 Larrabee Road, Westbrook

### Property Highlights

- Multiple suites available
- Available immediately
- Convenient access to Maine Turnpike/I-95, Exits 47 and 48



### Property Description

We are pleased to offer for lease Suite 150 at The Larrabee Complex. Located less than one mile from Exits 47 and 48 of the Maine Turnpike/I-95, the site is easily accessible and offers excellent visibility. The property is located directly across from an approved major retail development and is near the Portland International Jetport, the Maine Mall area, and Downtown Portland.



### Broker Contact

Frank O'Connor

foconnor@dunhamgroup.com

www.dunhamgroup.com

## Property Overview

Center Size	101,250± SF
Available Space	Suite 150 : 3,980± SF
Utilities	Municipal water and sewer, separately metered and paid by Tenant
HVAC	Gas-fired roof top units
Ceiling Heights	16-18'± (dropped to acoustical ceiling tiles)
Parking	Ample, free, on-site
Building Tenants	Advanced Auto Parts, Sherwin Williams, PhoEver Maine, Spa Tech, and Sim City Indoor Golf

**FOR LEASE : \$13.00/SF NNN**

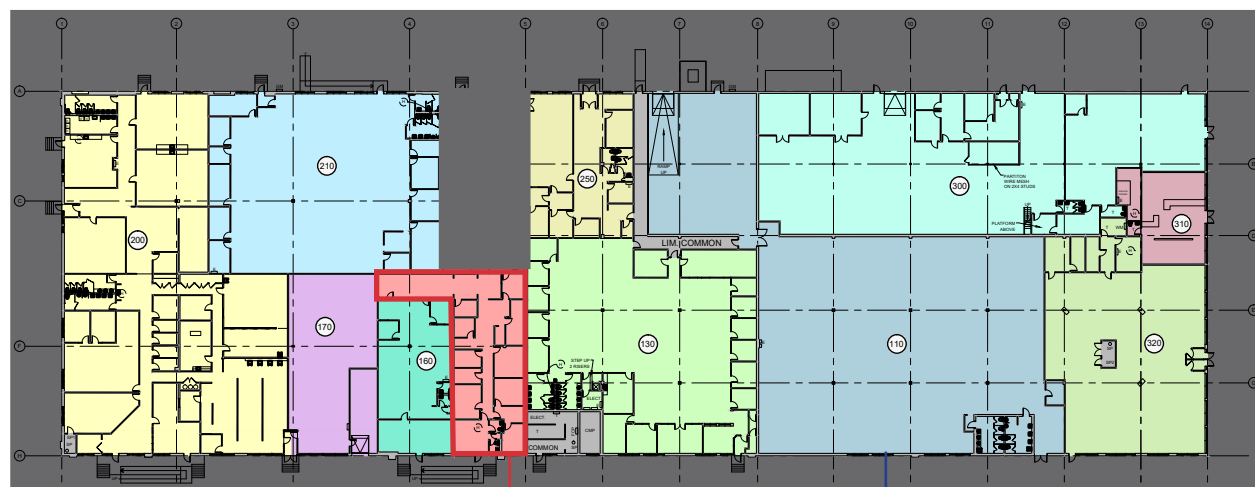

Suite 150  
3,980± SF